

Granville Arts Center

Small Theatre

Technical Specs – Quick Sheet

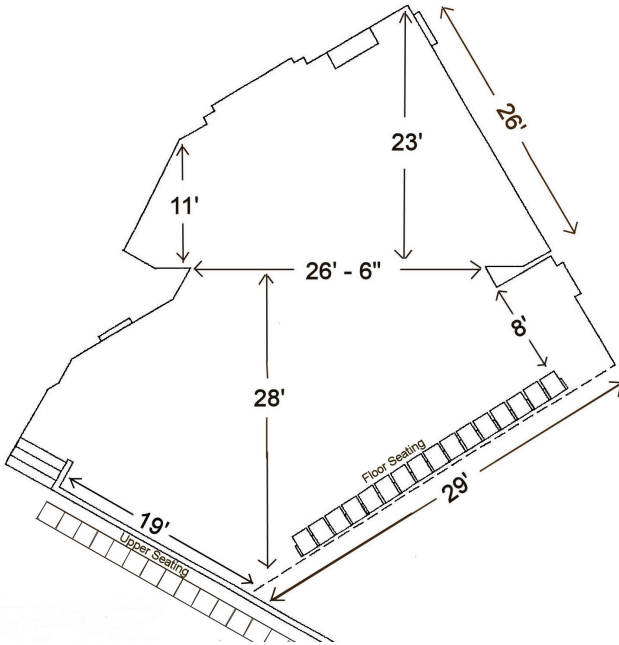

195 Permanent Seats. 3 Wheelchair Spaces. 10 Removable Seats.

Proscenium: Width: 26'-6"
 Height: 13'-5"
 Depth: Varies, see drawing
 Apron: Depth: Varies, see drawing
 Wing Space: SL: 2'
 SR: 4'
 Crossover: Upstage, behind black and through small scene shop
 Stage Height: Audience floor to stage floor 0' - 0"
 Floor: 3/4" plywood over oak floor painted satin black

Loading Dock:
 Ground level access from outside, uncovered, into scene shop with no elevated dock and no height restriction for trucks.
 Doors are 7'-6" x 7'-10" from outside into scene shop and 7'-6" x 7'-10" doors from shop to stage.

Dressing/Waiting:
 2 dressing rooms, 10' x 16', equipped with mirrors, lights, electrical plugs and restrooms.
 1 green room with small refrigerator.

Electrical:

Light Booth is in left rear of house.
 Main feed: 1000A; 3-phase
 Control: ETC Element
 96 Control Channel
 Dimmer per circuit – 130 -2.4kw circuits
 Electronic soft patch
 Connectors: L5 – 20p twist lock
 Follow spots: 2 Drama FS LED 700
 Luminaries: 1 Elation Platinum Spot III (fixed)
 2 ADJ VIZI CMY300 (fixed)
 10 TomShine Mini Movers (fixed)
 15 ETC ColorSource Pars (fixed)
 16 ETC Source 4 575 W (26")
 18 ETC Source 4 575 W (36")
 7 Fresnels 8" 1000W
 11 Fresnels 6" 1000W
 4 PAR 64 1000W

Rental Equipment:

These items are available for an additional rental charge:

- Follow spots
- Digital Keyboard
- Projector (fixed to hanged panels in the back of the stage)

Rigging:

Grid Height: 18'-6" Upstage
 20'-0" Downstage
 Loading area: Upstage center behind black
 Front Curtain: 15' Traveler Operation SL
 Legs and borders: 6' x 17' panels, black tracked

Audio/Visual:

Sound booth is in left rear of house.
 Console: Behrenger X32 Compact
 32 channels
 2 stereo master outputs
 4 mono / stereo submaster
 4 auxiliary outputs
 House: 2 QSC E112 passive speakers
 2 channel
 Playback: CD
 Comm: 6 Wireless EarTec headsets
 Wireless: 1 Shure LX4 wireless handheld
 Epson Pro 1405UNL Laser projector

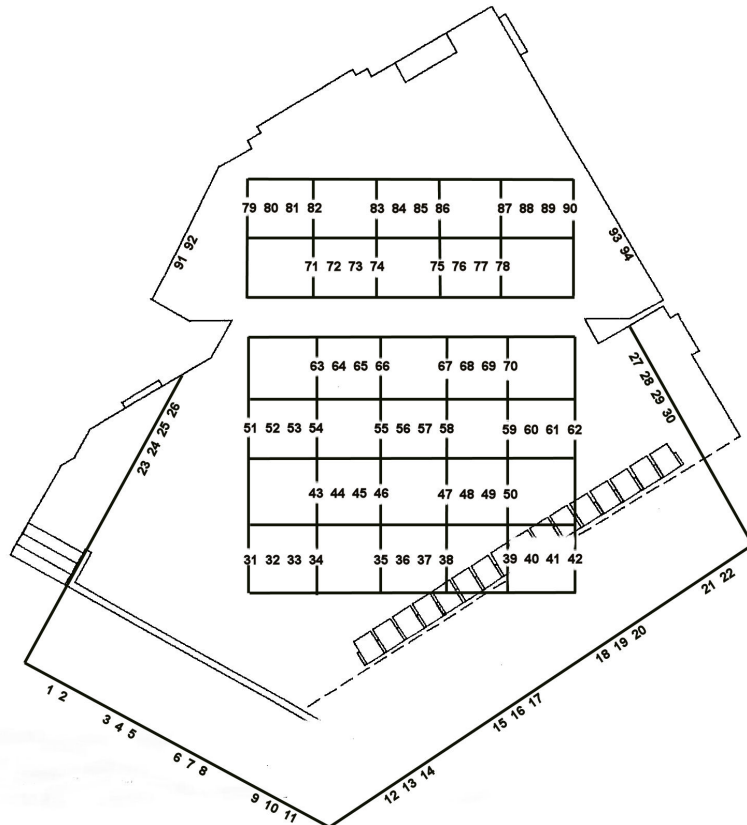

Technical Coordinator:

Theresa Clapper
 972-205-2786
tclapper@garlandtx.gov